



THE WORLD BANK

World Bank Financed Climate Smart Irrigated Agriculture Project (CSIAP)
Ministry of Mahaweli, Agriculture, Irrigation and Rural Development

SOCIAL SCREENING REPORT

MODERNIZATION AND DIGITALIZATION (CIVIL WORK) OF

AITHIYAMALAI AGRARIAN SERVICE CENTER -

BATALOIA DISTRICT



Submission

Deputy Project Director Office of the CSIAP – Eastern Province

30 – January – 2020

Contents

| | |
|--|----|
| 1. Project Description..... | 3 |
| 2. Social Screening Checklist | 12 |
| 3. Estimate of Specific Impacts and Information on Affected Persons..... | 21 |
| 4. Decision on Categorization..... | 21 |
| 5. Impact Categorization..... | 21 |
| 6. Submission of the Social Screening Report | 22 |
| 7. Social Management Plan for Aiththiyamalai ASC Modernization and Digitalization (Civil Work) | 24 |
| 8. Activity Plan for Aiththiyamalai ASC Modernization and Digitalization (Civil Work) | 27 |
| Annex: 01 A. Location map (Division map - Aiyithiyamalai ASC) | 28 |
| Annex: 02 Public/ Community Consultation and Disclosure..... | 30 |
| Annex: 04 Pictures during the meetings, discussions and field visits..... | 30 |

Abbreviation

| | |
|---------|---|
| ARAP | Abbreviated Resettlement Action Policy |
| ARPA | Agriculture Research and Production |
| ASC | Agrarian Service Centre |
| CBO | Community Based Organization |
| CKD | Chronic Kidney Disease |
| CSIAP | Climate Smart Irrigated Agriculture Project |
| DAD | Department of Agrarian Development |
| DSD | Divisional Secretariat Divisions |
| FGD | Focus Group Discussion |
| FO | Farmer Organization |
| GAP | Good Agricultural Practices |
| GND | GramaNiladhari Division |
| GOSL | Government of Sri Lanka |
| GRC | Grievance Redressal Committee |
| HAS | Hot Spot Areas |
| ICT | Information and Communication Technology |
| IEC | Information and Education Campaign |
| KII | Key Informant Interview |
| LKR | Lanka Rupee |
| MOH | Medical Officer of Health |
| PG | Producer Group |
| PMU | Project Management Unit |
| SA | Social Audit |
| SIA | Social Impact Assessment |
| SITHAMU | Sinhala Tamil and Muslim |
| SMP | Social Management Plan |
| SP | Southern Province |
| SSR | Social Screening Report |
| WB | World Bank |
| WFO | Women Farmer Organization |
| WHH | Woman Headed Household |

1. Project Description

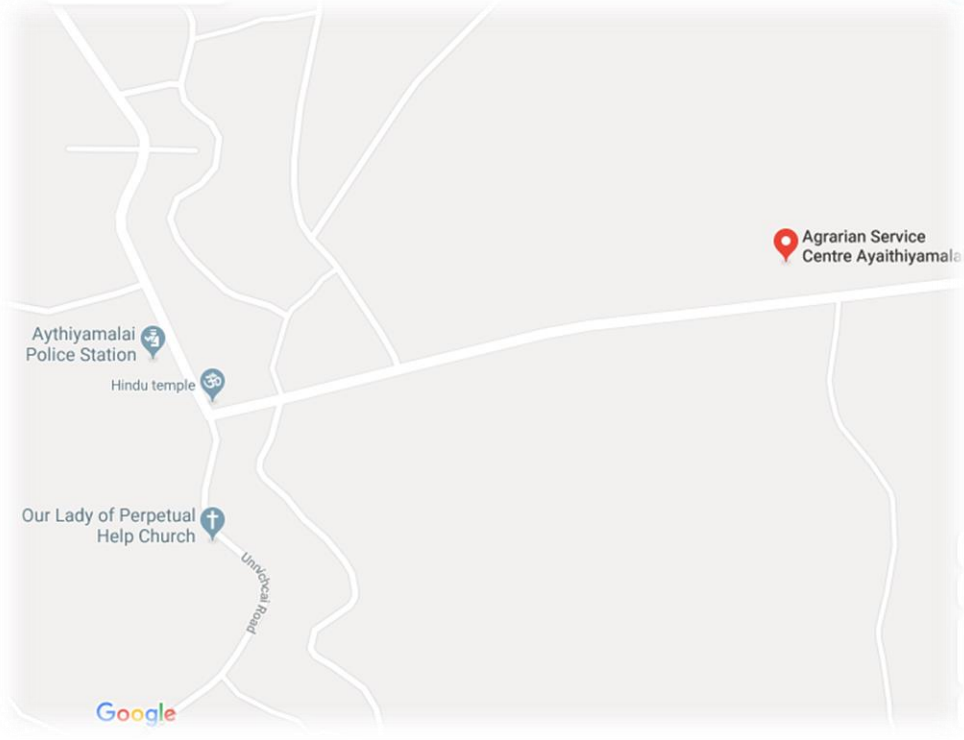
| | |
|--|--|
| Name of Sub project: | Aithiyamalai Agrarian Service Center Modernization and Digitalization (Civil Work) in Vavunatheevu DS Division in Batticaloa District. |
| Geographical coverage and location of the Subproject | <p>Province: Eastern Province District: Batticaloa District DS Division: Vavunatheevu DS Division ASC: Aithiyamalai ASC Located GND: Aithiyamalai North G.N Division Location Map:</p>  |
| Nature of the sub project: | It is mainly a Rehabilitation works of Aithiyamalai Agrarian Service Center at Vavunatheevu Divisional Secretariat Division in Batticaloa District. |
| Size/ scale/ Cost of the Sub Project | <p>Construction of Fertilizer Store - Rs. 5,208,290.14 Construction of Bike parking - Rs. 294,661.35 Construction of Boundary wall - Rs. 2,012,480.00 Total Civil Cost - Physical contingencies 5% - Vat 15% - Engineering & Administration 5% -</p> |
| Project implementing agency: | Department of Agrarian Development, Batticaloa which is the implementing agency. DAD with its network of officials based in the ASCs directly involves in implementing the subproject. Similarly, the staffs of the CSIAP based in national to divisional level will also involve in different stages of the implementation process appropriately. It is |

| | |
|--|---|
| | <p>expected that all the service providing agencies such as Department of Agriculture, Department of Irrigation, Forest Department, Department of wildlife, coconut development board etc. will also support to implement the subproject effectively. From the community side, FOs, agriculture committee associated with the ASCs, WFOs will also contribute to implement the project. Similarly, the farmers in general will support to implement the project by tolerating the difficulties that would be created during the construction period.</p> |
| Specific objective and beneficiaries of the sub project: | <p>Major objective: efficient and effective ASC to function in the CSIA Project area commencing from mid- 2010 as a productive one-stop service center contributing to achieve the project development objectives of CSIAP.</p> |
| Sub Project Descriptions: | <p>Proposed sub project of Aithiyamalai ASC include following activities, <u>New intervention works: -</u></p> <ol style="list-style-type: none"> 1. Construction of fertilizer stores 2. Construction of Bike parking 3. Construction of Boundary wall <p>No any repairing works proposed to the ASC.</p> <p>The sub project will be implemented during the period from January 2020 to October 2020.</p> |
| Land Acquisition | <p>The proposed subproject does not involve land acquisition.</p> |
| Subproject Justification and Alternative Analysis | <ul style="list-style-type: none"> ✓ Reasons for the modernize of the existing ASC (civil work) is majority of the respondent and the persons interviewed responded that the space available within the existing building was not adequate at all to provide a better service for the increased demand of the farmers. ✓ Officer space for running various units of the service providers of the government sector is not adequate. ✓ The fertilizer store is in a very small place, which is a place visited by large number of farmers daily. Storage facilities for fertilizers also limited. ✓ In many of the centres, there is no proper and spacious place with necessary equipment to conduct awareness programmes for the farmers. Sanitary and waiting room facilities for both the staff and the farmers are not in a satisfactory situation. Furniture available is also not adequate. |

- ✓ One common toilet is available in outside of building but that is not in good condition. And one washroom with toilet constructed inside of ASC building, but that is using by officers.
- ✓ Proper sanitary facilities needed for farmers. If repair washroom and toilet will helpful for farmers. Most of the peoples of this ASC division doing paddy cultivation.
- ✓ In front of the ASC, one side boundary wall available and also other three sides are covered with barbed wire so if we provide boundary wall that will help to protect from the surrounding places.
- ✓ Already sales centre building available in the ASC but the building use as canteen.
- ✓ Inside the ASC premises one bike parking also available but that space is not enough for park high number of bikes & vehicles.

General Profile of the Community

Under the Aithiyamalai ASC, there are 7 GND. The total number of households is 3116 and total number of women headed farm families are 429. The details are below:

Table No: 01 General Profile of the Community

| S.N | Name of the GND | Number of GND | No of Villages | Total Number of Families | Total Number of Farm Families | Total number of Woman Headed families |
|-----|---------------------|---------------|----------------|--------------------------|-------------------------------|---------------------------------------|
| 01 | Karaveddy | 183 | 10 | 649 | 200 | 103 |
| 02 | Mahilawaddawan | 184 | 05 | 541 | 125 | 79 |
| 03 | Unnichchai | 184 A | 07 | 379 | 295 | 49 |
| 04 | Ayithiyamalai North | 184 B | 06 | 678 | 398 | 85 |
| 05 | Ayithiyamalai South | 184 C | 05 | 308 | 125 | 46 |
| 06 | Narippulthottam | 184 D | 02 | 308 | 83 | 35 |
| 07 | Nediyamadu | 184 E | 08 | 253 | 175 | 32 |
| | Total | | 43 | 3,116 | 1,401 | 429 |

Source - Divisional statistical Hand book, Manmunai West, 2018

Table No: 02 Woman Headed Details in the ASC

| S/N | GN Division | Sub Total |
|-----|---------------------|-----------|
| 1 | Ayithiyamalai South | 46 |
| 2 | Mahilavaddavan | 79 |

| | | |
|--------------|---------------------|------------|
| 3 | Karaveddy | 103 |
| 4 | Naripulthoddam | 35 |
| 5 | Nediyamadu | 32 |
| 6 | Unnichei | 49 |
| 7 | Ayithiyamalai North | 85 |
| Total | | 429 |

Source - Resource profile, Manmunai West DS Division, 2018/2019

Table No: 03 Demographic Details

| S.N | G.N Division | Religion (Number of population) | | | | | Ethnicity (Number of families) | | |
|--------------|---------------------|---------------------------------|---------------|----------|------------|------------------|--------------------------------|-----------------|-----------|
| | | Buddhist | Hindus | Islam | R.C | Other Christians | Sinhaleas | Srilankan Tamil | Srilankan |
| 01 | Karaveddy | 0 | 2,045 | 0 | 21 | 0 | 0 | 649 | 0 |
| 02 | Mahilawaddawan | 0 | 1,812 | 0 | 52 | 0 | 0 | 541 | 0 |
| 03 | Unnichchai | 0 | 1,232 | 0 | 0 | 28 | 0 | 379 | 0 |
| 04 | Ayithiyamalai North | 0 | 2,313 | 0 | 02 | 0 | 0 | 678 | 0 |
| 05 | Ayithiyamalai South | 0 | 1,098 | 0 | 45 | 0 | 0 | 308 | 0 |
| 06 | Narippulthottam | 0 | 1,116 | 0 | 0 | 27 | 0 | 324 | 0 |
| 07 | Nediyamadu | 0 | 849 | 0 | 10 | 13 | 0 | 253 | 0 |
| Total | | 0 | 10,465 | 0 | 130 | 68 | 0 | 3132 | 0 |

Source - Resource profile, Manmunai West DS Division, 2018/2019

Primary livelihood of the community

Table No: 04 Primary livelihood of the community

| Category | Nos. |
|-------------------------------|------|
| Farmers | 1106 |
| Others | 1074 |
| Govt.Servant(Except teachers) | 64 |
| Semi- Govt | 05 |
| NGO | 39 |
| Private | 121 |
| Fisherman | 719 |
| Self | 442 |

Source - Resource profile, Manmunai West DS Division, 2018/2019

| Nature of the land ownership for the subproject | Land of the existing ASC owned by the DAD. ASC located with adequate and processes underutilized lands for the proposed construction. Therefore, the proposed civil work will not have any risks from having to obtain additional land. Therefore, the subproject activities can be implemented without causing any displacement or impact to people living adjacent to the ASC. Issues in resettlement will not arise. | | | | | | | | | | | | | | | | | | | | | | | | | | | | | | | | | | | | | | | | | | | | | | | | | | | | | | | | |
|--|---|-----------|-------------|-----------|-----------|-----------|-----------|-----------|----|----------|----|----|----|---|---|----|---------------|----|----|---|---|---|----|-----------|----|----|----|----|-----|----|----------------------|----|----|----|----|---|----|----------------------|----|----|----|---|---|----|---------------|-----|-----|----|----|----|----|------------|----|----|----|---|---|
| Land ownership pattern of people in the area (Ex: squatters, titleholders, tenants)? | <p>Table No: 05 Land Ownership - Paddy Land (Number of Families)</p> <table border="1" data-bbox="500 394 1563 793"> <thead> <tr> <th>S. N</th> <th>GN Division</th> <th>1 to 2 AC</th> <th>2 to 5 AC</th> <th>5 to 10AC</th> <th>Over 10AC</th> <th>Land less</th> </tr> </thead> <tbody> <tr> <td>01</td> <td>Karavedy</td> <td>82</td> <td>74</td> <td>05</td> <td>-</td> <td>-</td> </tr> <tr> <td>02</td> <td>Mahilaveduwan</td> <td>13</td> <td>25</td> <td>2</td> <td>-</td> <td>-</td> </tr> <tr> <td>03</td> <td>Unichchai</td> <td>57</td> <td>38</td> <td>08</td> <td>04</td> <td>195</td> </tr> <tr> <td>04</td> <td>Aiyathiyamalai North</td> <td>95</td> <td>45</td> <td>28</td> <td>16</td> <td>-</td> </tr> <tr> <td>05</td> <td>Aiyathiyamalai South</td> <td>13</td> <td>25</td> <td>01</td> <td>-</td> <td>-</td> </tr> <tr> <td>06</td> <td>Naripulthotam</td> <td>115</td> <td>120</td> <td>40</td> <td>05</td> <td>14</td> </tr> <tr> <td>07</td> <td>Nediyamadu</td> <td>58</td> <td>07</td> <td>03</td> <td>-</td> <td>0</td> </tr> </tbody> </table> <p>Source - Resource profile, Manmunai West DS Division, 2018/2019</p> <p>1. Major land extent - 8219 Acre, 3 Roots, 22.79 Perches</p> <p>2. Minor land extent - 150 Acre, 2 Roots, 00 Perches</p> <p>3. Rainfed land extent - 1466 Acre, 0 Roots, 30.99 Perches</p> | S. N | GN Division | 1 to 2 AC | 2 to 5 AC | 5 to 10AC | Over 10AC | Land less | 01 | Karavedy | 82 | 74 | 05 | - | - | 02 | Mahilaveduwan | 13 | 25 | 2 | - | - | 03 | Unichchai | 57 | 38 | 08 | 04 | 195 | 04 | Aiyathiyamalai North | 95 | 45 | 28 | 16 | - | 05 | Aiyathiyamalai South | 13 | 25 | 01 | - | - | 06 | Naripulthotam | 115 | 120 | 40 | 05 | 14 | 07 | Nediyamadu | 58 | 07 | 03 | - | 0 |
| S. N | GN Division | 1 to 2 AC | 2 to 5 AC | 5 to 10AC | Over 10AC | Land less | | | | | | | | | | | | | | | | | | | | | | | | | | | | | | | | | | | | | | | | | | | | | | | | | | | |
| 01 | Karavedy | 82 | 74 | 05 | - | - | | | | | | | | | | | | | | | | | | | | | | | | | | | | | | | | | | | | | | | | | | | | | | | | | | | |
| 02 | Mahilaveduwan | 13 | 25 | 2 | - | - | | | | | | | | | | | | | | | | | | | | | | | | | | | | | | | | | | | | | | | | | | | | | | | | | | | |
| 03 | Unichchai | 57 | 38 | 08 | 04 | 195 | | | | | | | | | | | | | | | | | | | | | | | | | | | | | | | | | | | | | | | | | | | | | | | | | | | |
| 04 | Aiyathiyamalai North | 95 | 45 | 28 | 16 | - | | | | | | | | | | | | | | | | | | | | | | | | | | | | | | | | | | | | | | | | | | | | | | | | | | | |
| 05 | Aiyathiyamalai South | 13 | 25 | 01 | - | - | | | | | | | | | | | | | | | | | | | | | | | | | | | | | | | | | | | | | | | | | | | | | | | | | | | |
| 06 | Naripulthotam | 115 | 120 | 40 | 05 | 14 | | | | | | | | | | | | | | | | | | | | | | | | | | | | | | | | | | | | | | | | | | | | | | | | | | | |
| 07 | Nediyamadu | 58 | 07 | 03 | - | 0 | | | | | | | | | | | | | | | | | | | | | | | | | | | | | | | | | | | | | | | | | | | | | | | | | | | |
| Gender Issues | <p>Following gender issues are concerning in the impact area of the Aiyithiyamalai ASC:</p> <ul style="list-style-type: none"> ✓ In the ASC Division men and women farmers are actively participated in every farming activities and women farmers actively involved in land preparation, seeding, planting, weeding harvesting, preparation for marketing and also contribute to livestock management. ✓ In this ASC Division 14 Farmer organizations and 20 Women Farmer Organizations are actively participated in each GN Divisions. ✓ In Farmer Organizations males are dominated in decision making process and less opportunity for female participants and low-level female representation in rural level farmer organizations. ✓ WFO also actively participated in paddy farming activities and they do not have much opportunity to benefit from extension services. | | | | | | | | | | | | | | | | | | | | | | | | | | | | | | | | | | | | | | | | | | | | | | | | | | | | | | | | |

| | |
|--|---|
| | <ul style="list-style-type: none"> ✓ Women headed families are mostly involved in Home Garden activities and their fields are damaged by monkeys and elephants and they also loss their family income and faced much difficulties such as poverty, malnutrition, mental stress etc. ✓ Most of the Female headed households are living in rural areas and restricted for gathering the knowledge in technical business skills and access to markets. ✓ Male Farmers are working continuously in farming process and women acts as caregivers and laborers prevent them from accessing technical trainings, workshops and extension services. ✓ In the farming activity, allocated payment of wages for female labour is much less than the male labour. However female labours are hired as unskilled labours for agricultural activities without proper allocated wages. ✓ Female farmers do not have land ownership which restrict to access the water facilities and fertilizer subsidies. |
| Social Capital – community-based organizations | <p>The following community-based organizations identified in Aithiyamalai ASC division.</p> <ul style="list-style-type: none"> - Farmer Organization (FO): 14 - Woman Farmer organization (WFO): 20 - Rural Development society (RDS): 17 <p>Source – Agrarian Service Center, Aithiyamalai</p> |
| On-going Development Projects | <p>There are no development projects being implemented in the project area.</p> |
| Frequenting Visitors | <p>“Unnichai tank” popular in here so outside local peoples coming here for tourism purpose.</p> <p>Outside paddy farmers doing paddy cultivation in this ASC range.</p> <p>Whole sale fish market available in here so outside peoples comes for fish business.</p> <p>Farmers (Men and Women) visit to ASC for getting fertilizer and subsidies.</p> |
| Social Impacts Positive Impacts | <ul style="list-style-type: none"> • This subproject will benefit the local population of the area, especially for farming communities. • The proposed activities mostly benefited to farmers. Sanitation facilities lead to ensure hygienic condition of peoples who lives in the ASC division it will also ensure to get pure drinking water to peoples. |

| | |
|------------------|---|
| | <ul style="list-style-type: none"> • ASC will also serve as a place for ASC staff and community to interact, to share knowledge and create awareness about project. Therefore, the ASC will enhance community participation and relationships between ASC staff and farmers. • Once the project is complete, benefits will start to flow almost immediately with the onset of rain and the long term through enhanced resilience. • The two communities interacting with each other, government officers and contractors in the process of jointly conducting social auditing, participating in irrigation water management, training and extension, business development and marketing will reap benefits in the form of valuing working together despite differences along with increased knowledge and awareness. • Overall, the completed project will bring about poverty deduction, inclusive development and shared prosperity. • CSIAP staffs and community people share their knowledge and make awareness of this project through this Community participation also enhanced. Staff of ASC division and farmer's relationship will enhance. • The sub project includes construction of fertilizer store, which will help to increase capacity of store of fertilizer. That will lead to increase to accessibility to farmers for paddy cultivation. • The sub project will provide high-quality advisory services for farmers and agribusinesses in Aithiyamalai. • CBO's involve in Social that will lead to encourage project activities and identify any issues. |
| Negative Impacts | <ul style="list-style-type: none"> • During office hours noise and dust come from the construction work that will disturb to officers and farmers. Materials storage and machinery parking somewhere near the site will also cause some disturbances to the community. • A labour camp may be established and there could be impacts from labour influx-however, will be very minimum considering that only |

| | |
|----------------------------|---|
| | <p>limited number of labourers (approximately 5) may come from outside.</p> <ul style="list-style-type: none"> • When constructions are carried around schools, maximum precautions are required to ensure the safety of children. Due to curiosity children may try to enter into the worksites and look through the manholes or meddle with the equipment etc. |
| <p>Mitigation Measures</p> | <ul style="list-style-type: none"> • The social issues in any infrastructure developments project are common and cannot be avoided. Also, it is important to note that the majority of social issues are emerged and aggravated due to absence of realistic methods of constructions and systematic approach. • For an example, contractor will be required to do water sprinkling to minimize impacts from dust and carry out noise generating work during day time while ensuring noise generating work during day time while ensuring noise pollution is kept to the minimum. Public access to the site to be prohibited or controlled via adequate fencing and signage in order to avoid risk to the public. • There should be special arrangements at worksites closer to schools at the time of starting and closing of schools. • All contractors will be required to develop and implement written labour management procedures, including procedures to establish and maintain a safe working environment. • Adequate care and measures will be taken to avoid any violation of use of labour, accidents, or disputes with local communities due to use of non-local labour force used for constructions, risks associated with influx of non-local workers. • The contractors would be encouraged to use as much as possible locally hired labour. • Since the civil construction works will be carried out using proper construction practices and there will be no adverse impacts on the properties, residential and other structures of the community located at a distance from the site. However, there will be some temporary impacts due to the project implementation in respect of which mitigation measures are proposed. • The contractor will also be required to employ an environmental and social officer to address any issues that may crop up during project implementation. All contractors will be required to develop and |

| | |
|--|---|
| | <p>implement a code of conduct for labourers, including procedures to establish and maintain a safe working environment. The staff and workers will be given an orientation on appropriate behaviours to ensure no disturbance to the community life and officers of the ASC.</p> <ul style="list-style-type: none">• Through the relevant officials the FOs will request the contractor for employing local labour to the maximum extent possible and hire village vehicles for material transport. Any individual requests for service by the contractor will be conveyed to the authorities and will be attended to without compromising the project activities and social and environmental concerns.• The mitigation measures including the appointment of an environmental and social officer, will be included in the specifications for the main contract, and monitored by the project management to ensure compliance.• Grievance redress mechanism and Social Audit Committees will be established to ensure project benefits sharing, community needs in development planning and community engagement in implementation. |
|--|---|

| 2. Social Screening Checklist | | | | |
|--|-----|----|--|---|
| Screening/ assessment questions Project type | Yes | No | Low/ mediu m/ maj or impact s | Description/ Details |
| Background | | | | |
| 1. Will the subproject/ intervention include new physical construction work? (Attach a copy of technical design) and what is extent of the works - small, medium, large? | √ | | Low | Construction of Fertilizer store. Construction of bike parking. Construction of Boundary wall. These are medium scale construction |
| 2. Does the subproject/ intervention include upgrading or rehabilitation of existing physical facilities? (Attach a copy of technical design) and what is extent of the works - small, medium, large ? | | √ | | |
| Project site and land acquisition and Livelihood Related Impacts | | | | |
| 3. Is the site chosen for this work free from encumbrances (Ex: squatters, crops, trees, houses, other structures walls etc) | √ | | | One small Neem tree (<i>Azadirachta indica</i>) identified (2.5m height) in ASC boundaries site. If we go for construction of Boundary wall want to cut off the tree. According EMF that will solved. |
| 4. Is the site chosen for this work in possession of the implementing agency? | √ | | | Department of Agrarian Development, Batticaloa which is the implementing agency. |
| 5. If the land is owned by other government agencies, has action been taken to transfer these lands to CSIAP managing entity? (Attach evidence of transfer) | | √ | | The identified land belongs to Agrarian Department - Batticaloa. |

| | | | | |
|---|---|---|--|---|
| 6. Does the sub project intervention require acquisition of private land? | | √ | | |
| 7. If the land parcel has to be acquired, is the actual plot size and ownership status known? (Mention the details) | | | | Not Applicable |
| 8. If the site is privately owned, can this land be purchased through negotiated settlement? | | | | Not Applicable |
| 9. If any land required for the work is privately owned, are these land owners willing to voluntarily donate the required land for the CSIAP rehabilitation / development? (if yes attach the concern letter) | | | | Not Applicable |
| 10. Will the affected land/ structure owners likely to lose less than 10% of their land of structures area? | | | | Not Applicable |
| 11. If so, are these land or structure owners willing to voluntarily donate the required land for this sub project? | | | | Not Applicable |
| 12. If the land owners are willing to donate the land, do they lose more than 10% of their land / structure in this location due to of donation? | | | | Not Applicable |
| 13. Are there any previous land acquisition where the identified land has already been acquired? | | √ | | |
| 14. Is the land for material mobilization vehicular movement, transport for the civil work available within the identified worksite or right way? | √ | | | Land for the material mobilization vehicular movement and transport for the civil work are available. Near the construction site, there are no sensitive areas observed. Therefore, lack of parking space will not be serious issue in the subproject area. |

| Project impacts | | | | |
|--|--|---|--|---|
| 15. Is the project/ intervention likely to cause any permanent damage to or loss of housing, other assets, resources use? | | √ | | |
| 16.If yes, are these damages likely to be full or partial (Ex: entire structure having to be demolished versus part of the structures being damaged?) | | | | Not Applicable |
| 17. Will there be loss of / damage to agricultural lands, standing crops, trees due to acquisition of lands, construction of facilities etc? | | √ | | |
| 18. Will there be any permanent or temporary loss of income and livelihoods because of the civil works? If so for what period? Also, please specify whether it is likely to be temporary or permanent. | | √ | | |
| 19. Have these people/ businesses who may suffer temporary or permanent loss of incomes or livelihoods been surveyed and identified for payment of any financial assistance? | | | | Not Applicable |
| 20. Will there be any adverse impacts (inconvenience/ restriction of access, damage to properties) on the people/ communities due to construction related transport/ other activities etc? | | √ | | But during working hours there will be some disturbances to staff i.e. from noise and dust. |
| 21. Will there be any impacts on cultural, community properties or facilities? | | √ | | |
| 22. Will the project cause any other temporary or permanent impacts? Pls describe | | √ | | |
| Livelihoods related impacts | | | | |
| 23. Is there any loss of crops, assets, business etc. | | √ | | |
| 24. Are there any non-titled people (squatters) who are living/ or doing business who may be partially or fully affected because of the civil works? | | √ | | |

| | | | | |
|--|---|---|--|--|
| 25. Have measures been planned to mitigate temporary impacts including ease of access? Give details? | √ | | | Temporary impacts will be addressed/mitigated according to the SIMP. |
| Resettlement impacts | | | | |
| 26. Does this project involve resettlement of any person? if yes, give details | | √ | | |
| 27. Is there any physical displacement of persons due to project construction? | | √ | | |
| 28. Does this project cause any temporary relocation of people during construction? | | √ | | |
| 29. Is there any economic displacement (possibility to move out, close of business/ commercial/ livelihood activities of persons) during construction? | | √ | | |
| 30. Will people permanently or temporarily lose access to facilities, services, or natural resources? e.g firewood collection and other rural livelihood sources linked to forests and government land | | √ | | |
| 31. Are there any vulnerable people/ groups (poorest/ women headed households/ elderly families, single parents, families with disable persons) living in the proposed locations or affected / benefitted by the project intervention? (give the number) | √ | | | <p>Vulnerable people/groups will not be negatively affected due to the civil works. They will be benefitted directly or indirectly.</p> <p>The details are below: 539 families identified as woman headed families in the ASC. 52 widows due to war affected, 382 widows identified due to natural causes.</p> |

| | | | | |
|---|---|---|---|--|
| | | | | Source: Resource profile, Manmunai West DS Division, 2018/2019. |
| 32. Are there any indigenous people living in the proposed locations or affected/ benefitted by the project intervention? (give the number) | | √ | | |
| Impacts from labor influx | | | | |
| 33. Will the project potentially involve an influx of workers to the project location? | √ | | | |
| 34. Will the influx be considered significant for the local community? | √ | | | |
| 35. How many workers will be needed for the sub project, with what skill set, and for what period? | √ | | | Approximately 9 skilled workers and 23 unskilled workers are needed for 3-4 months. |
| 36. Can the project hire workers from the local workforce? And what is the size and skill level of the existing local workforce? | √ | | | Skill workers - Male - 123, female - 68 Unskilled workers - Male - 2530, Female - 1413. |
| 37. If the skill level of the local workforce does not match the needs of the project, can they be trained within a reasonable timeframe to meet project requirements? | √ | | | Workforce is available at the local community and contractor will bring his workforce if needed. |
| 38. Will there be workers brought in from outside? | √ | | | |
| 39. How will the workers be accommodated? Will they commute or reside on site? If so, what size of camp will be required? | | | √ | They will find a house for rent. |
| 40. Based on the socio-economic, cultural, religious and demographic qualities of the local community and the incoming workers, is there a possibility that their presence or interaction | | | √ | Hence, majority of the incoming workers would be from similar socio-economic, cultural, |

| | | | | |
|---|---|---|--|--|
| with the local community could create adverse impacts? | | | | religious or demographic background. Around 10,775 peoples mother tongue is Tamil. |
| 41. Will the incoming workers use or create competition for these resources? | | √ | | |
| 42. What is the expected duration of the incoming workers' presence in the community? Or frequency and extent of contact between the local community and outsiders? | | | | Approximately 3-4 months. |
| 43. Will the incoming workers be from a similar socio economic, cultural, religious or demographic background? | √ | | | Most Probably similar. |
| 44. Given the characteristics of the local community, are there any adverse impacts that may be anticipated? | | √ | | The local community is Tamil speaking and majority of them are Hindus. So same language speaker will be preferable for minimized unwanted social issues. |
| 45. Is the project located in a rural or remote area? | √ | | | The identified project site is located in a rural area. |
| 46. Is the project located / being carried out in an area that is not usually frequented by outsiders? | √ | | | Aithiyamalai is a tourist place. "Unnichai tank" popular in here so outside local peoples coming here for tourism purpose. Outside local peoples coming here for tourism purpose. Outside paddy farmers doing paddy cultivation in this ASC range. |

| | | | | |
|---|---|---|--|---|
| | | | | Whole sale fish market available in here so outside peoples comes for fish business. Farmers (Men & Women) visit to ASC for getting fertilizer and subsidies. |
| 47. Are there sensitive social conditions that need to be considered? | | √ | | |
| Community participation | | | | |
| 48. Has the project received community consent and support? | √ | | | Two discussions conducted with ADO and DO and GN. |
| 49. Are there any CBOs or other that exist in the selected locations? | √ | | | WFO - 20, RDS - 23, WRDS - 12, FO - 21, Fisheries society - 05 |
| 50. Will the project mobilize these CBOs for GRM/ Social Audit/ etc activities? | √ | | | Grievance Redressal Committee will be established to address/resolve issues. |
| 51. If CBOs are involved, do these organizations have prior experiences in GRM/ Social Audit/ etc practices? | | √ | | The project has to be trained the people. |
| 52. Do the CBOs identified for the CSIAP activities transparent and accountable and free from any form of corruption/ abuse? | √ | | | |
| 53. Will the project expect any counterpart contribution from the beneficiary households? (if yes, what is the expected contribution) | √ | | | Community can support with Shramadana activities, 5 persons from each FO can contribute two hours per day siramadana activities. (e.g. unskilled voluntary work). |

| Gender Based Violence | | | | |
|---|---|---|--|--|
| 54. Is the subproject in an area of the district with a humanitarian or emergency situation? | | √ | | Rehabilitation works of ASC Aithiyamalai. |
| 55. Undertaken consultations with women's groups? | √ | | | In the ASC Division arranged community consultant meeting, men and women farmers were participated in meeting and no arranged separate meeting with women farmers. Discussions conducted with ASC staffs and women Development officer in DS Division. |
| 56. Issues related to GBV and GBV-related concerns about the project have arisen in the community engagement discussions? | | √ | | Gender based issues not identified during the community consultant meeting and discussion. |
| 57. Are military or paid security forces being contracted as part of the project? (Having military or paid security forces contracted as part of a project can increase the risk of GBV.) | | √ | | Contract with registered Contractors. |
| 58. Is the project district in lowest poverty quartile of country? (Regions in the lowest poverty quartile of a country may be underserved and the most vulnerable to neglect) | √ | | | National Poverty line value of Sri Lanka Rs. 4,897.00 expenditure for person per month in Batticalo District Rs.4989.00 (Department of census & Statistics - Sri Lanka October, 2019) - 2422 families income come under below Rs. 10,000.00. |

| | | | | |
|---|---|---|--|--|
| | | | | <p>- 450 families income come under above Rs.10, 000.00 (Income details annexed)</p> <p>(Resource Profile, 2018 Divisional Secretariat, Manmunai west).</p> |
| 59. Is the subproject in hard-to-supervise areas? (Lower risk is easily accessed project areas. Higher risk is hard-to-supervise areas) | | √ | | Risk free area and easily accessible area. |
| 60. Is the subproject construction near school route or other pedestrian access that women and girls use for their daily activities? | | √ | | <p>Aiyithiyamalai ASC come to under the Manmunai West Predeshiya Sabah, vavunativu and around 150 family members and public are used this route continuously.</p> <p>Schools - 02 Religious Places - 03 Government offices - 04 Markets - 01 Shops - 01 Not identified sensitive place of this ASC area.</p> |
| 61. Will the subproject be able to monitor implementation across the full span (both in terms of geographic spread and duration) of the work? | √ | | | |
| 62. Will female workers be in close proximity to male workers with limited supervision? | √ | | | In the ASC modernization civil work male and female farmers would like to involve |

| | | | | |
|--|--|--|--|---|
| | | | | in “Shramadana” work and no any issues in working together with male workers under the limited supervision. WFO and WRDS members also can contribute one day for “Shramadana” work. |
|--|--|--|--|---|

3. Estimate of Specific Impacts and Information on Affected Persons

| Estimates of specific impacts | Number/ Amount/ Ha |
|---|--------------------|
| - Private land required (Sq. m) | 0 |
| - Total number of households affected | 0 |
| - Number of individuals losing more than 10% of land area | 0 |
| - Government land required | yes |
| - Number of shops affected | 0 |
| - Number of utilities affected | 0 |
| - Number of workers to be brought from outsides | Not Known |

4. Decision on Categorization

| | |
|--|---|
| Decision on Categorization, after reviewing the answers above, it is determined that the sub project will have: | |
| High/ substantial impacts | |
| Moderate impacts | |
| Low/ no impacts | √ |

5. Impact Categorization

| |
|--|
| Conclusion and Screening Decision (to be filled by the PMU) |
| Social impacts of the proposed sub project <ul style="list-style-type: none"> • <u>No Impacts: there is no land acquisition because these are permit lands and no loss of livelihoods if the works are completed during the dry/off season , Social Screening</u> |

Report (SSR), Social Impact Management Plan (SIMP) [required if civil works involved]...√.....

- Minor Impacts: Less than 200 individuals affected; no physical displacement; & affected persons lose less than 10% of their productive assets, SSR, Abbreviated Resettlement Action Policy (ARAP), SIMP.....Temporary impacts only. SSR with SMP submitted.....
- Significant Impacts: More than 200 individuals affected; cause physical displacement; affected persons lose more than 10% of productive assets, SSR, SIA, census survey, RAP with R&R assistance & income restoration measures.....

6. Submission of the Social Screening Report

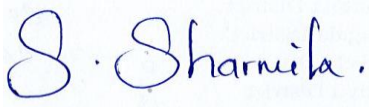
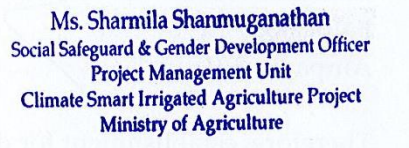
| | |
|---|--|
| <p>Submission By:</p>  <p>T. Sekaran Social Safeguard Officer DPD Office - Eastern Province Date:30.01.2020 Email: thsekar@gmail.com Contact No: 077-5228125</p>  <p>S.Kayalvili Gender Development Officer DPD Office - Eastern Province Date:30.01.2020 Email: tdkkayal@gmail.com Contact No: 077-4149390</p> | <p>Report Reviewed and Recommended By:</p>  <p>Ms. Sharmila Shanmuganathan Social Safeguard and Gender Development Officer Project Management Unit (PMU) Climate Smart Irrigated Agriculture Project (CSIAP) Date: 30 - 01 - 2020 Email: sociologistsharmila@gmail.com Contact No: 077-2437310</p>  <p>Ms. Sharmila Shanmuganathan Social Safeguard & Gender Development Officer Project Management Unit Climate Smart Irrigated Agriculture Project Ministry of Agriculture</p> |
|---|--|

This SSR cleared by Mr. Shanek Fernando, Social Development Specialist – The World Bank.

Approved By:



Project Director

Climate Smart Irrigated Agriculture Project (CSIAP)

7. Social Management Plan for Aiththiyamalai ASC Modernization and Digitalization (Civil Work)

| Social Impact Mitigation Plan for the ASC modernization and Digitalization (Civil Work) Subproject | | | | |
|--|--|--|--|--|
| Issues/ Impacts and risks | Mitigation Measures | Institutional Responsibility | | Mitigation Cost |
| | | Implementation | Supervision / Monitoring | |
| General (for all types of risks, issues and disturbances) | <ul style="list-style-type: none"> A GRM will be established to receive and resolve complaints/grievances related to disturbances caused by construction including GBV related issues. Awareness will be created on the GRM among community and ACS staff and will publicly display the contact details to report grievances. Awareness will be created among community on risks/issues including GBV issues due to labour influx arising from construction activities and safety/ mitigation measures that will be in place. | Social/Environment safeguard officer - ACS/CSIAP | PMU | Included in sub project's safeguards budget. |
| Disturbances due to heavy machinery movement & temporary use of land for material storage and parking. | <ul style="list-style-type: none"> An officer will be appointed to implement & monitor social/environment safeguards mitigations measures during construction. Community and ACS staff will be informed of construction activities/schedule, and mitigation measures that will be in place. | Contractor | Social/Environment safeguard officer - ACS/CSIAP | Included in construction cost. |

| | | | | |
|--|--|------------|--|--------------------------------|
| | <p>Consultation with ACS staff and community will be conducted to identify land for material storage, camp setup, equipment parking and routes to transport material that cause minimum disturbances to community & ACS activities.</p> <p>If there are damages caused to local roads and other utilities during construction, contractor shall attend to the repairs/rectification of the damages.</p> | | | |
| Construction related disturbances from noise & dust etc. | <ul style="list-style-type: none"> Dust barriers will be installed surrounding the construction. Water sprinkling will be done to minimize impacts from dust. Dust masks to be provided to all laborers for the use at required times. The construction will be carried out in a manner to minimize noise pollution. The construction works with heavy sound should will be timed to avoid office working time period. | Contractor | Social/Environment safeguard officer - ACS/CSIAP | Included in construction cost. |
| Labour Influx related issues (e.g. GBV) | <ul style="list-style-type: none"> Local labour will be hired where possible - Contractor will give priority to women when hiring. Worker Code of Conduct will be included as part of the employment contract - this should define workers' commitment in attitudes and behaviour to preventing, combating and responding GBV. | Contractor | Social/Environment safeguard officer - ACS/CSIAP | Included in construction cost. |

| | | | | |
|---|---|------------|--|--------------------------------|
| | <ul style="list-style-type: none"> Contractors will implement robust measures to prevent sexual harassment/GBV including training of workforce and sanctions for non-compliance (e.g. termination). | | | |
| Public/ occupational safety Hazards, and on impacts on environment. | <ul style="list-style-type: none"> Public access to the site will be prohibited or controlled via adequate fencing and signage in order to avoid risk to the public. Contractors shall take precautions to minimize mosquito breeding, where the pit fills with water. Environment Management Plan will provide more details regards measures to prevent/mitigate impacts to the environment including pollution, deforestation, soil erosion and management of solid waste. | Contractor | Social/Environment safeguard officer - ACS/CSIAP | Included in construction cost. |

Annex: 01 A. Location map

(Division map - Aiyithiyamalai ASC)

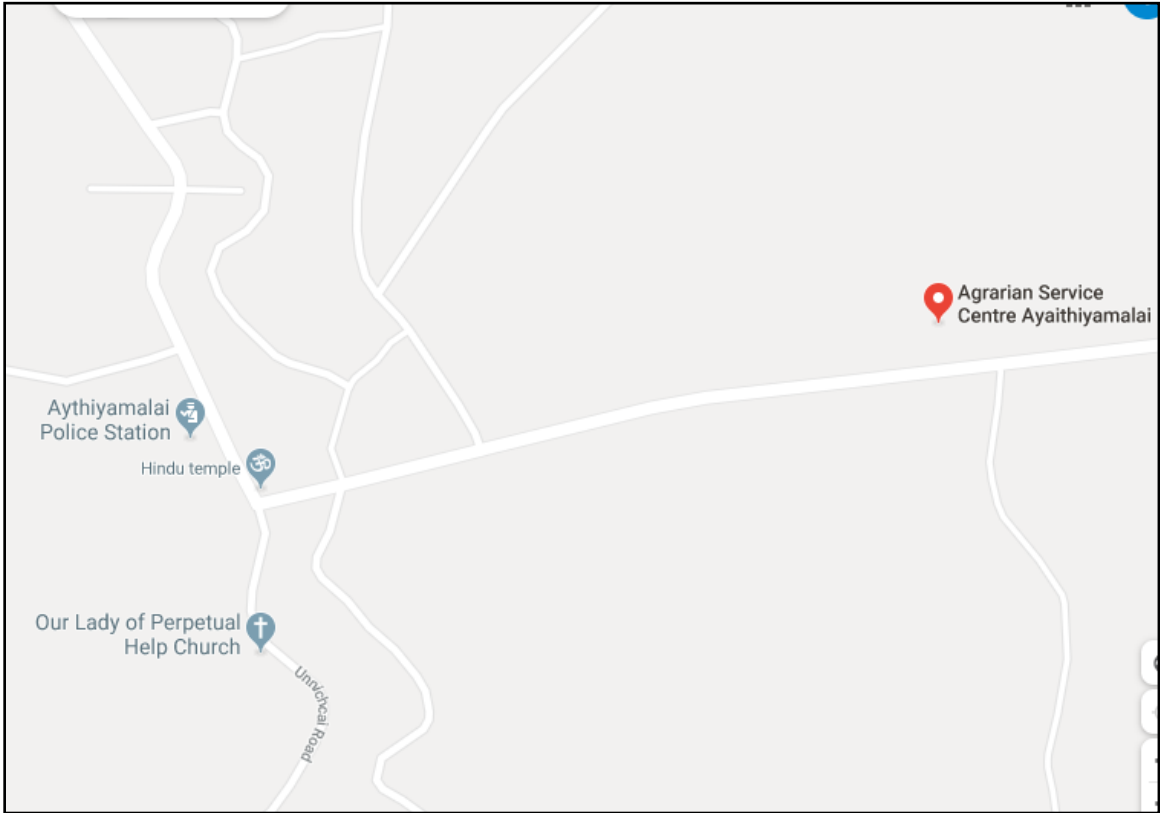

Annex: 01 B. Aithiyamalai Agrarian Service Center Plan

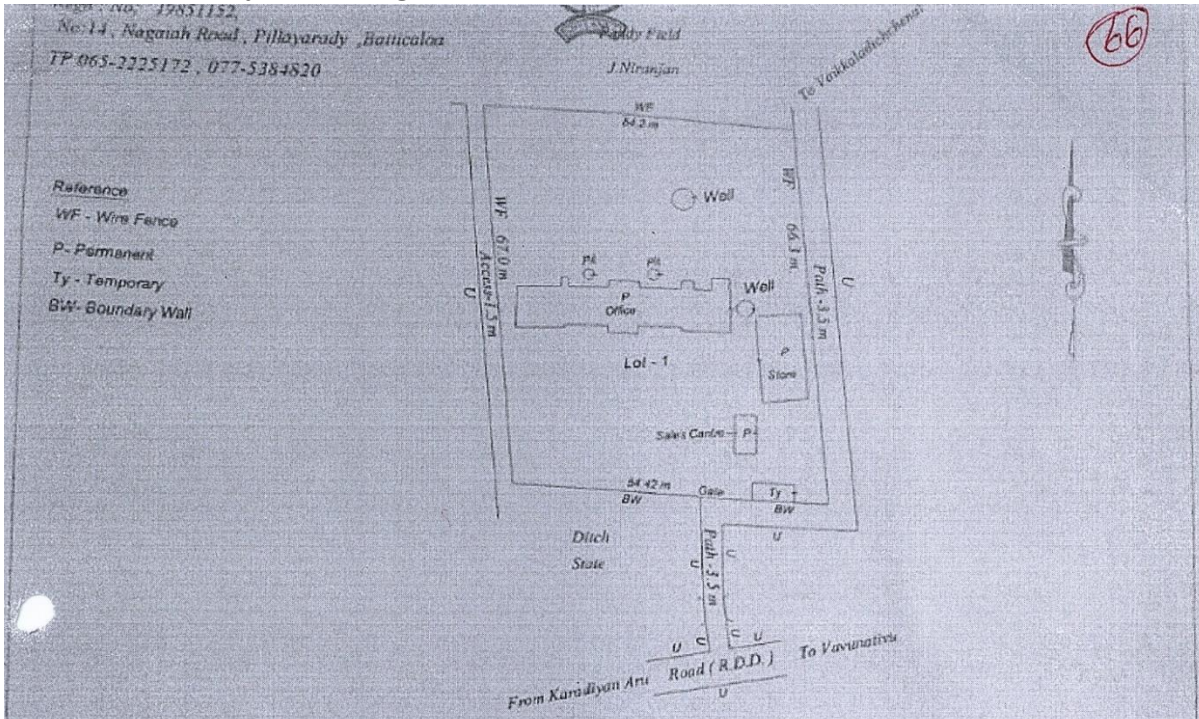

Scale :- 1:1000

PLAN

OF An ALLOTMENTS OF LAND is called "A.P.C.Land"

bearing Assesment No.s : G.N.Divn - Ayittiyamalai North -184 B , Within the Predeshiya Sabha limits of Manmunai West Situated in Ayittiyamalai Road , Ayittiyamalai Village in Manmunai West Divisional Seceretary area in Batticaloa District in the Eastern Province of the Democratic Socialist Republic of Sri Lanka

BOUNDED AS FOLLOWS

- North by : Paddy Field - J.Niranjan
- East by : Path
- Southby : Path & State Land
- West : Access

Boundaries Pointed out by - M.A.Rasheed , Agrarian Development Officer , Ayittiyamalai
T.Jeyakumar , Management Assistant , Agrarian Development Dept,
Ayittiyamalai

| Lot | Containing in Extent Hectares | A. R. P. | | |
|-----|----------------------------------|----------|----|-------|
| | | A. | R. | P. |
| 1 | 0.3574 | 0 | 3 | 21.30 |

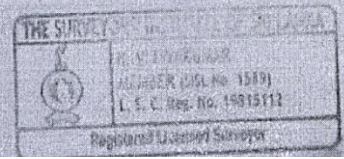

Annex: 02 Public/ Community Consultation and Disclosure

| Public / Community consultation conducted Location/ Venue | Consultation method | Date | Number of participants (Male, Female) | Details/Issues raised |
|--|-----------------------------|------------|--|-----------------------|
| Aithiyamalai Agrarian Service Center | Focus group Discussion | 09/12/2019 | M- 05 F -06 | - |
| Aithiyamalai Preschool Building | Focus group discussion abut | | M -08 F- 11 | |

Annex: 04 Pictures during the meetings, discussions and field visits

Focus Group discussion



Fertilizer Store – Inadequate space for store fertilizer



Existing Sales Center



Existing Bike Parke



Annex: 06 Further Statistical Datas about Aithiyamalai ASC Division

Table 01: Population Details

| S.N O | Name of the GND | Number of GND | No of Villages | Total population | Male | Female | Total Number of Families | Total Number of Farm Families | Total number of Woman Headed families |
|----------|------------------------|------------------|-------------------|---------------------|--------------|--------------|-----------------------------------|--|--|
| 01 | Karaveddy | 183 | 10 | 2,066 | 1,013 | 1,053 | 649 | 200 | 103 |
| 02 | Mahilawaddawan | 184 | 05 | 1,864 | 929 | 935 | 541 | 125 | 79 |
| 03 | Unnichchai | 184 A | 07 | 1,260 | 634 | 626 | 379 | 295 | 49 |
| 04 | Ayithiyamalai North | 184 B | 06 | 2,315 | 1,144 | 1,171 | 678 | 398 | 85 |
| 05 | Ayithiyamalai South | 184 C | 05 | 1,143 | 556 | 587 | 308 | 125 | 46 |
| 06 | Narippulthottam | 184 D | 02 | 1,144 | 588 | 587 | 308 | 83 | 35 |
| 07 | Nediyamadu | 184 E | 08 | 872 | 430 | 442 | 253 | 175 | 32 |
| | Total | | 43 | 10,664 | 5,294 | 5,401 | 3,116 | 1,401 | 539 |

Source: Resource Profile, 2018 Divisional Secretariat, Manmunai west

Table 02: Religious and Ethnicity Details

| S. N | G.N Division | Religion (Total Number) | | | | | Ethnicity (Number of families) | | |
|---------|---------------------|-------------------------|--------|-------|-----|------------------|--------------------------------|-----------------|-----------------|
| | | Buddhist | Hindus | Islam | R.C | Other Christians | Sinhalese | Srilankan Tamil | Srilankan Moors |
| 01 | Karaveddy | | 2045 | - | - | - | - | 649 | - |
| 02 | Mahilawaddawan | | 1812 | - | - | - | - | 541 | - |
| 03 | Unnichchai | | 1232 | - | - | - | - | 379 | - |
| 04 | Ayithiyamalai North | | 2313 | - | - | - | - | 678 | - |
| 05 | Ayithiyamalai South | | 1098 | - | - | - | - | 308 | - |
| 06 | Narippulthoddam | | 1116 | - | - | - | - | 324 | - |

| | | | | | | | | | |
|----|------------|--|-----|---|---|---|---|-----|---|
| 07 | Nediyamadu | | 849 | - | - | - | - | 253 | - |
|----|------------|--|-----|---|---|---|---|-----|---|

Source : Resource Profile, 2018 Divisional Secretariat, Manmunai west

Table 03: Income Level in GN Division -Aiyithiyamalai ASC Division

| S.NO | GN.Division | Income Level in Rs. (per month per family) | | | | |
|--------------|----------------------|--|-------------------------|--------------------------|--------------------------|--------------------|
| | | Less than Rs.5,000 | Rs.5,001.00 - 10,000.00 | Rs.10,001.00 - 15,000.00 | Rs.15,001.00 - 25,000.00 | Above Rs.25,001.00 |
| 01 | Karavedy | 410 | 137 | 33 | 21 | 17 |
| 02 | Mahilaveduwan | 196 | 214 | 94 | 20 | 16 |
| 03 | Unichchai | 65 | 60 | 125 | 32 | 20 |
| 04 | Aiyithiyamalai North | 560 | 50 | - | 20 | - |
| 05 | Aiyithiyamalai South | 102 | 137 | 20 | 02 | 01 |
| 06 | Naripulthotam | 275 | 21 | 10 | 03 | 01 |
| 07 | Nediyamadu | 147 | 48 | 13 | 02 | - |
| Total | | 1755 | 667 | 295 | 100 | 55 |

Source : Resource Profile, 2018 Divisional Secretariat, Manmunai west

Table 04: Skilled and Unskilled Labour Population by GN.Division - 2018

| S. No | GN Division | Skilled Labours | | Un-Skilled Labours | |
|--------------|----------------------|-----------------|-----------|--------------------|-------------|
| | | Male | Female | Male | Female |
| 01 | Karacedy | 32 | 21 | 518 | 132 |
| 02 | Mahilaveduwan | 30 | - | 447 | 29 |
| 03 | Unnichchai | 23 | 16 | 284 | 64 |
| 04 | Aiyithiyamalai North | 20 | 26 | 1046 | 1129 |
| 05 | Aiyithoyamalai South | 08 | - | 123 | 30 |
| 06 | Naripulthotam | 01 | 03 | 112 | 29 |
| 07 | Nediyamadu | 09 | 02 | - | - |
| Total | | 123 | 68 | 2530 | 1413 |

Source : Resource Profile, 2018 Divisional Secretariat, Manmunai west

Table 05: Widows Details in GN Division

| S.N | GN Division | Total Number of widows |
|-----|----------------------|------------------------|
| 01 | Karavedy | 103 |
| 02 | Mahilaveduwan | 81 |
| 03 | Unichchai | 49 |
| 04 | Aiyathiyamalai North | 88 |
| 05 | Aiyathiyamalai South | 45 |
| 06 | Naripulthotam | 36 |

| | | |
|--------------|------------|------------|
| 07 | Nediyamadu | 32 |
| Total | | 434 |

Source : Resource Profile, 2018 Divisional Secretariat, Manmunai west

Table: 06 Details of Community Based Organization under the A.S.C

| S.N | Type of the local organizations | Number & Name of the local organizations |
|-----|---------------------------------|---|
| 01 | WFO - 20 | Nelloor WFO, Manipuram WFO, Senthamarai WFO, Vasantham WFO, Kannagi WFO, Neervili WFO, Mullamunai WFO, Barathi WFO, Velavan WFO, Katkuda WFO, Karaveddiyar WFO, Uthayam WFO, Katputhanai WFO, Ayithiyamalai North WFO, Vaaikaladichenai WFO, Nelluchchenai WFO, Ayithiyamalai South WFO, Panankandadichchenai WFO, Unnichchai WFO, 8 TH MilePostWFO, Nachchuwanvely WFO |
| 02 | Farm Organization - 14 | Senkathir FO, Makilkathiron FO, Unnichchai FO, Ayithiyamalai FO, Manipuram FO, Aathawan FO, PanankandadichchenaiFO, Ponnankannichchenai FO, Palamurugan FO Kilakkodichchenai FO, Kathiravan FO, Olimadu Nediyamadu FO, Vinayagar FO, Marutham FO, |
| 03 | RDS - 17 | Nediyamadu RDS Ayithiyamalai South |

| | | |
|--|--|--|
| | | Ayithiyamalai South Unnichchai Unnichchai Unnichchai Unnichchai Karaveddi Nelluchchenai Mullamunai Narippulthoddam Katkudah Makilavaddawan Nelloor Manipuram Katputhanai AYithiyamalai North |
|--|--|--|

Source : ASC, Aiyithiyamalai.

Table 07: Details of existing social infrastructures in the A.S.C

| S.N | Name of Infrastructure | No of existing | Ownership |
|-----|------------------------|-------------------|------------|
| 01 | Schools | 10 | Government |
| 02 | Health centers | 03 | Government |
| 03 | Hospitals | 02 | Government |
| 04 | Places of worships | Hindu Temples | 31 |
| 05 | | Buddhist Temple | — |
| 06 | | Mosque | — |
| 07 | | Church | 02 |
| 08 | Roads | Agriculture roads | 28 |
| 09 | | Public road | 33 |

Source : ASC, Aiyithiyamalai.

Table 08: Name of Villages in Aithiyamalai ASC Range

| S/No | GN Division | Code No | Villages |
|------|-----------------|---------|--|
| 1 | Narippulthottam | 184 D | 1. Narippulthoddam 2. NachchuwanKovil Village |
| 2 | Mahilawaddawan | 184 | 1. Kalkudah 2. Kantharapuram 3. Thillanthooddam 4. Sinnaththooddam 5. Mahilawaddawan |

| | | | |
|---|--------------------|-------|--|
| 3 | Karaveddy | 183 | <ol style="list-style-type: none"> 1. Vaddiyal 2. Karaveddy 3. Mudakkumadu 4. Valaichchenai 5. Panankandadichchenai 6. Vilamunai 7. Nelluchchenai 8. Koolavadichchenai 9. Arasadichchenai 10. Mullamunai |
| 4 | Aithiyamalai South | 184 C | <ol style="list-style-type: none"> 1. Ayiththiyamalai South 2. Vaikkaladichchenai 3. Kilakkodichchenai 4. Olimadu 5. Ponnankannichchenai |
| 5 | Aithiyamalai North | 184 B | <ol style="list-style-type: none"> 1. Manipuram 2. Pallachchenai 3. Nellur 4. Ayiththiyamalai North 5. Katputhanai 6. Mathurankandadichchenai Part |
| 6 | Nediyamadu | 184 E | <ol style="list-style-type: none"> 1. Nediyamadu 2. Koliyanaaru Part 3. Thavanaimadu 4. Padukadu 5. Kurakkanchenai 6. Kalikkulam 7. Olimadu part 8. Mathurankandadichchenai part |
| 7 | Unnichchai | 184A | <ol style="list-style-type: none"> 1.Mavilaiyaaru 2.Rasathurai Nagar 3.Unnichchai 4.Kuravanthidal 5.Karaveddiyaaru 6.Kuthamba 7 Mail Post |

Source - Resource profile, Manmunai West DS Division, 2018/2019
